

ok

4-22-13

Mr. Lawson

McCreary Central Board of Education will do the following to narrow the disparities between the baseball and softball facilities.

McCreary County Board of Education will enclose the visiting team dugout after the completion of the 2013 season with a starting date of June 1st 2013 and completion date of October 15th 2013.

McCreary County Board of Education will renovate an area for office space at the softball field with a starting date of November 1st 2013 and completion date of February 10, 2014.

Based on consultation with the architect, locker rooms and restrooms facilities will start July 1st 2014 and will be completed no later than July 1st 2017.

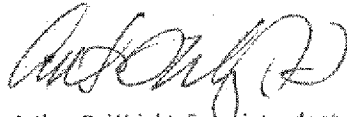

Arthur D. Wright, Superintendent

McCreary County School District



ok
Def
5-15-13

McCreary Central High School
Locker Rooms and Athletic Storage Space

500 C	Girls Basketball Office
501 B	Girls basketball Dressing Room
501 C	Girls Basketball Storage
503	Boys basketball Office
503 B	Boys Basketball Dressing Room
503 C	Boys Basketball Storage
504	Volleyball Office
501 B	Volleyball Dressing Room
504 C	Volleyball Storage
504 B	Boys Cross Country Dressing Room
801 D	Tennis, Cross Country ,Soccer and Softball Office
804	Football office
801 A	Wrestling Office
801 B	Football Storag
806	Football and Wrestling Dressing Room
808	Girls Cross Country, Soccer, Softball and Tennis Dressing Room
807 A	Soccer and Softball Storage
807 B	Cross Country and Tennis Storage
800 A	Wrestling Storage

ATHLETIC BUILDING

FOOTBALL FIELD

01-07-09 arV.1

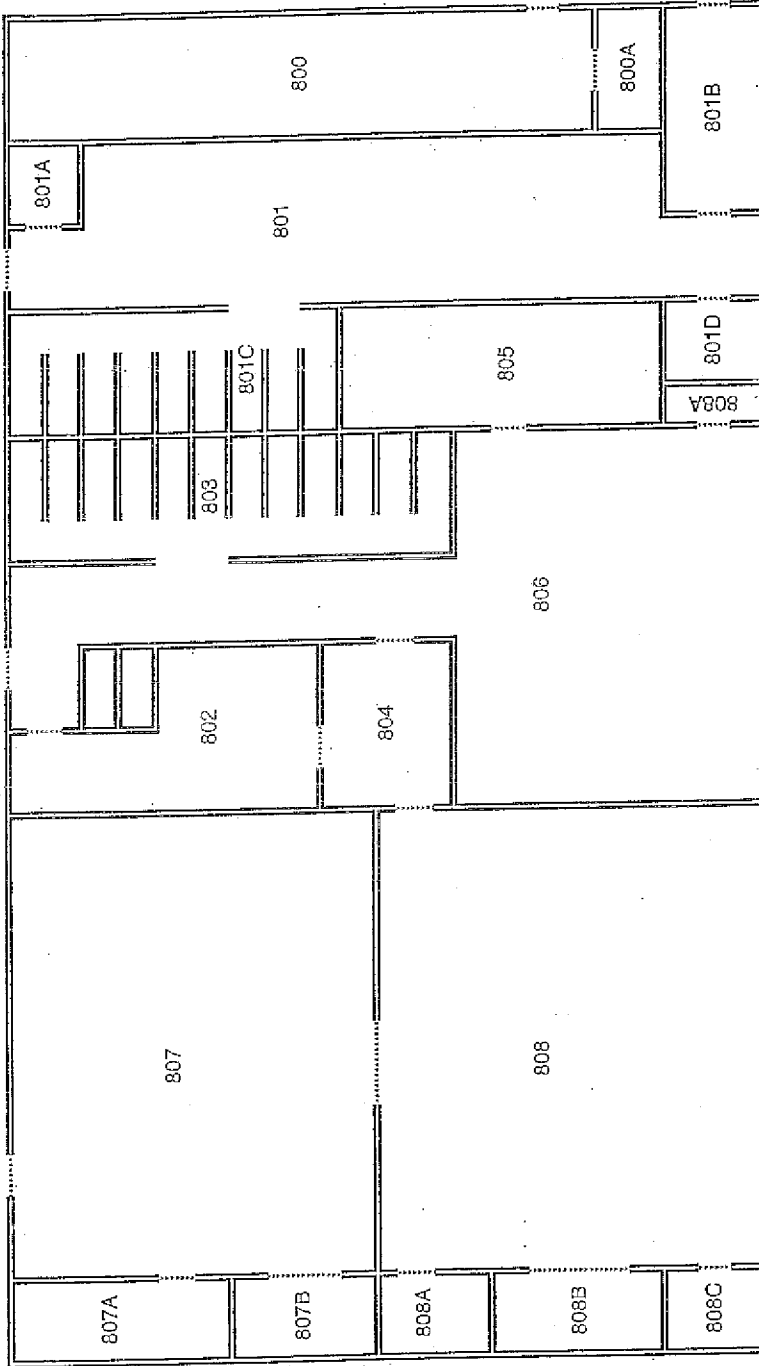

BASEBALL FIELD

BBFB
(BaseBall-
FootBall)

Baseball
Storage Shed 2
BS2

Baseball Concession Stand
BCS1

Baseball Storage Shed 1
BS1

Baseball Batting Cage
BBC

BBC	Baseball Batting Cage
BS1	Baseball Storage Shed 1
BCS1	Baseball Concession Stand 1
BS2	Baseball Storage Shed 2
BBFB	BaseBall or FootBall Fields

GYMNASIUM - 500 Wing
01-07-09 at V.1

S3
Parking
Lot

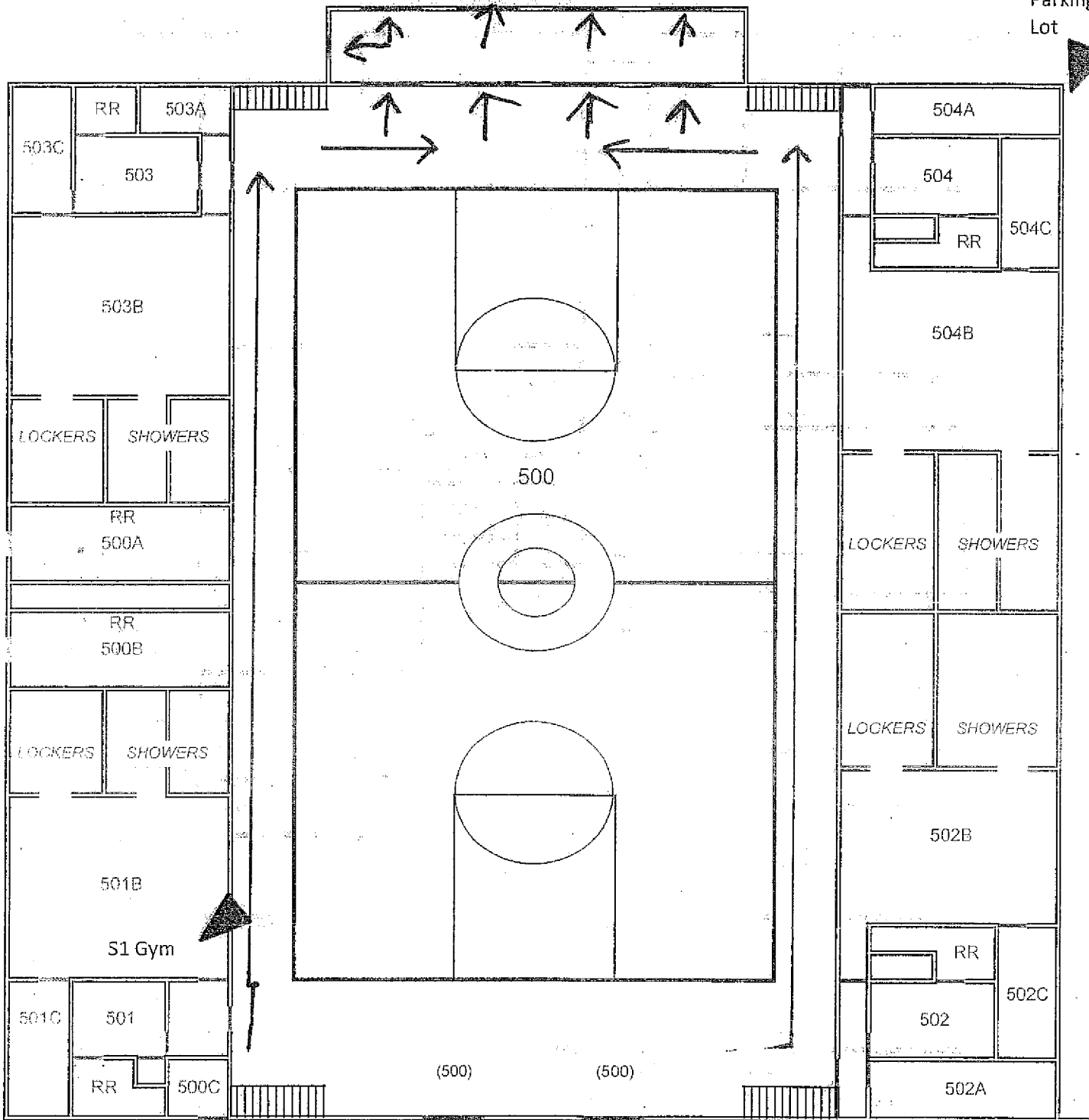

S1 Gym Hall

ok
accus

Calendar

August, 2013

Calendar

July 2013							August 2013							September 2013						
S	M	T	W	T	F	S	S	M	T	W	T	F	S	S	M	T	W	T	F	S
30	1	2	3	4	5	6	28	29	30	31	1	2	3	1	2	3	4	5	6	7
7	8	9	10	11	12	13	4	5	6	7	8	9	10	8	9	10	11	12	13	14
14	15	16	17	18	19	20	11	12	13	14	15	16	17	15	16	17	18	19	20	21
21	22	23	24	25	26	27	18	19	20	21	22	23	24	22	23	24	25	26	27	28
28	29	30	31	1	2	3	25	26	27	28	29	30	31	29	30	1	2	3	4	5
4	5	6	7	8	9	10	1	2	3	4	5	6	7	6	7	8	9	10	11	12

Sunday	Monday	Tuesday	Wednesday	Thursday	Friday	Saturday
28	29	30	31	Aug 1 Girls Sports 3:00 to 5:30	2	3
4	5 Boys Sports 3:00 to 5:30	6 Girls Sports 3:00 to 5:30	7 Boys Sports 3:00 to 5:30	8 Girls Sports 3:00 to 5:30	9 Open Weight Room	10
11	12 Boys Sports 3:00 to 5:30	13 Girls Sports 3:00 to 5:30	14 Boys Sports 3:00 to 5:30	15 Girls Sports 3:00 to 5:30	16 Open Weight Room	17
18	19 Boys Sports 3:00 to 5:30	20 Girls Sports 3:00 to 5:30	21 Boys Sports 3:00 to 5:30	22 Girls Sports 3:00 to 5:30	23 Open Weight Room	24
25	26 Boys Sports 3:00 to	27 Girls Sports 3:00 to 5:30	28 Boys Sports 3:00 to 5:30	29 Girls Sports 3:00 to 5:30	30 Open Weight Room	31

Weight Room

We will purchase small hand weights, light training balls and some athletic bands for 2013-2014 school year.

Possible in the near future as funds come available looking to purchase a universal machine.

ok guy
5-20-13

Self-Analysis in relation to Athletic Spending

Two areas in which the spending most favor the male athletes

1. Travel
2. Coaching salaries

McCreary Board of Education added extended days to volleyball to close the gap on Male and female coaching salaries.

4 boys teams with extended days

3 Girls teams with extended days with the addition of volleyball to extended days extra service pay is equal.

Spending significantly favors male athletes.

1. Wrestling
2. Baseball

Male's teams will not be allowed overnight trips with exception of team qualifying for state tournament.

Monitor Expenditures

The Principal, Athletic and Bookkeeper will meet monthly to review expenditures to make sure pending is equity for males and females.